

**45**

  
**apreamare**

**GOZZO**

**45**

**A journey into the  
Mediterranean yachting culture**



**GOZZO 45**  
**For Gentleman only**

---



WATCH THE VIDEO















1822

APREAMARE

GOZZO 45



GOZZO

45



1826

APREAMARE

GOZZO

45

1827

APREAMARE



1829

APREAMARE

GOZZO

45







**GOZZO 45**  
**Style matters**

---











1847

APREAMARE

GOZZO

45



GOZZO

45

1853

APREAMARE

1855

APREAMARE

GOZZO

45





**GOZZO 45**  
Away from the crowd

---



















**GOZZO 45**  
Interior with a view

---



















**GOZZO 45**  
Finest details

---

**GOZZO 45**









1822 APREAMARE GOZZO 45 GOZZO 45 1826 APREAMARE



GOZZO 45 1827 APREAMARE 1829 APREAMARE GOZZO 45





# Data sheet / Scheda Tecnica

## 1 PROPULSION

2 X VOLVOPENTA D8-600 - shaft line

2 X VOLVOPENTA IPS 700

## 2 SPEED (knots)

	VP D8-600		VP IPS 700
Maximum speed	31	knots	33
Cruising speed	25	knots	27

## 3 RANGE

	VP D8-600		VP IPS 700
Maximum speed	192	n.m.	278
Cruising speed	241	n.m.	350

## 4 MAIN DIMENSIONS

Length overall (LOA)	14,70	m.	48 ft. 3 in.
Hull/homologation length	13,00	m.	42 ft. 8 in.
Waterline length	12,55	m.	41 ft. 2 in.
Maximum beam	4,70	m.	15 ft. 5 in.
Draft	1,30	m.	4 ft. 3 in.
Displacement unladen	12,0	ton./lb.	26455
Displacement laden	16,0	ton./lb.	35274
Max. number of persons on board	16		
Navigation/homologation category CE	B		

## 5 ADDITIONAL DATA

Variable geometry hull type with support skids

Maximum height for transportation	4,75	m.	15 ft. 7 in.
Fuel tank capacity	1600	lt./US gals.	423
Fresh water tank capacity	350	lt./US gals.	92
Black water tank capacity	77	lt./US gals.	20

\* All data's are merely indicative, refer to a standard model, and therefore have no contractual value. Apreamare, in the light of a continuous improvement, reserves the right to change and/or update them at any time and without prior notice.

\* I dati tecnici, prestazionali e di autonomia sono meramente indicativi e riferiti ad un modello standard, e non hanno pertanto alcun valore contrattuale. Apreamare, in ottica di continuo miglioramento, si riserva di variarli e/o aggiornarli in qualunque momento e senza preavviso.

apreamare | GOZZO 45

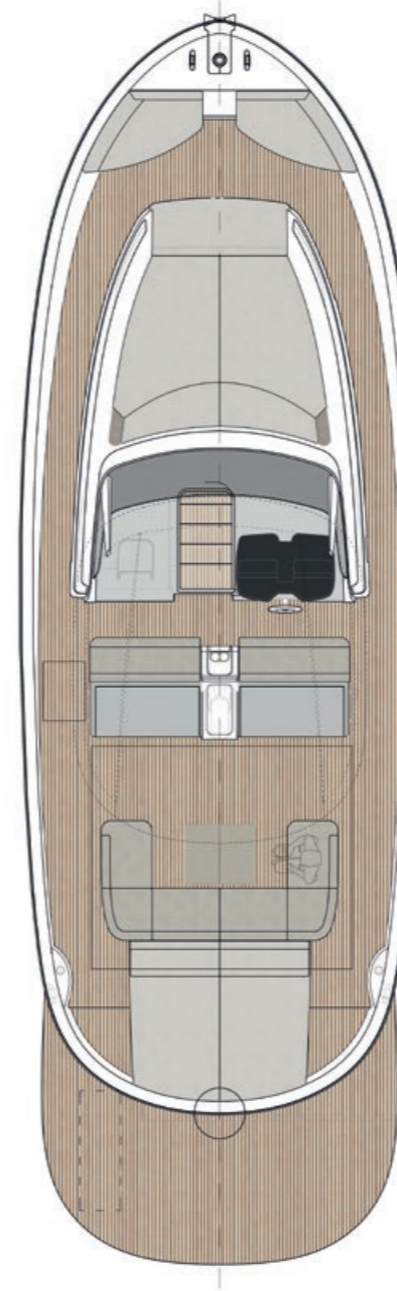

Standard layout

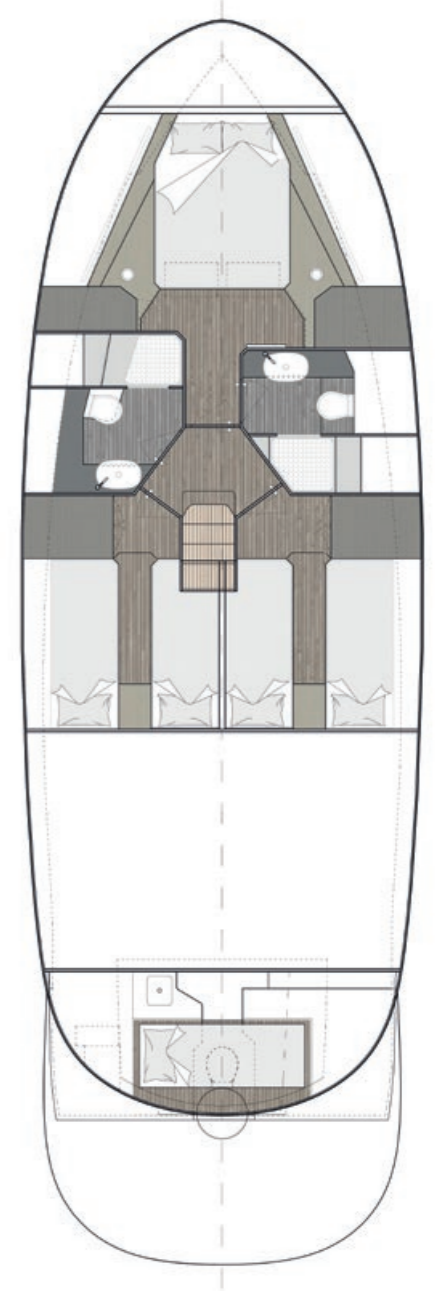

Optional layout





INTERIOR/EXTERIOR DESIGN  
Marco Casali - Too Design

NAVAL ARCHITECTURE  
Umberto Tagliavini  
Marine Design & Service

PHOTOS  
Blue Passion  
Guerrieri Visual

DECOR  
Casaross Sorrento  
PIEMME Piacere Mediterraneo  
Rosalinda Acampora





**apreamare**

**MEDITERRANEAN YACHTING CULTURE**

Apreamare Yachts

Via Terragneta, 72 - 80058 Torre Annunziata (NA)

Tel: +39 081 537 8411

[www.apreamare.it](http://www.apreamare.it)